

Course & Dist. Down
 Juniata River from ash
 to Walnut S 25 E 33 P.
 South 13 P.
 N 85 E 78 to Walnut

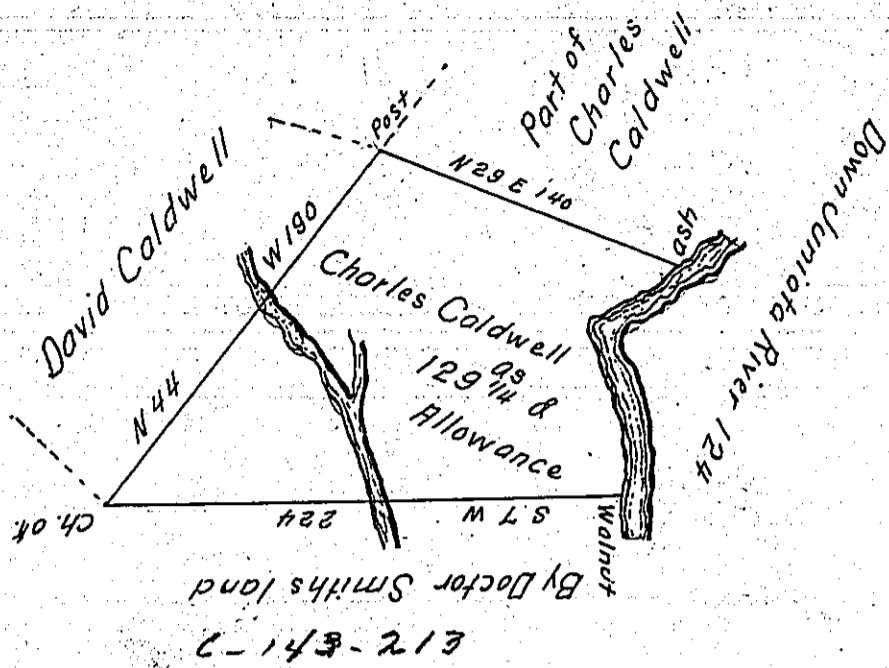

Situate in Huntingdon Township & County on the South Side of Juniata River
 Containing one Hundred & Twenty nine & one fourth acres & the usual allowance
 of Six per Cent for Roads Surveyed the 18th day of January 1804.

Samuel Cochran Esquire S. G.

John Canan D. S.

Note the above is a part of a Larger Tract Originally Surveyed and Returned to
 Charles Caldwell in pursuance of his Warrant Dated the 28th day of April 1763.

J. Canan

IN TESTIMONY that the above is a copy of the original remaining on file in
 the Department of Internal Affairs of Pennsylvania, made
 conformably to an Act of Assembly approved the 16th day of
 February, 1833, I have hereunto set my Hand and caused
 the Seal of said Department to be affixed at Harrisburg,
 this fourteenth day of April 1904.

Isaac R. Brown
 Secretary of Internal Affairs.